

(99)3.10-01
Rev. 03.09.2007

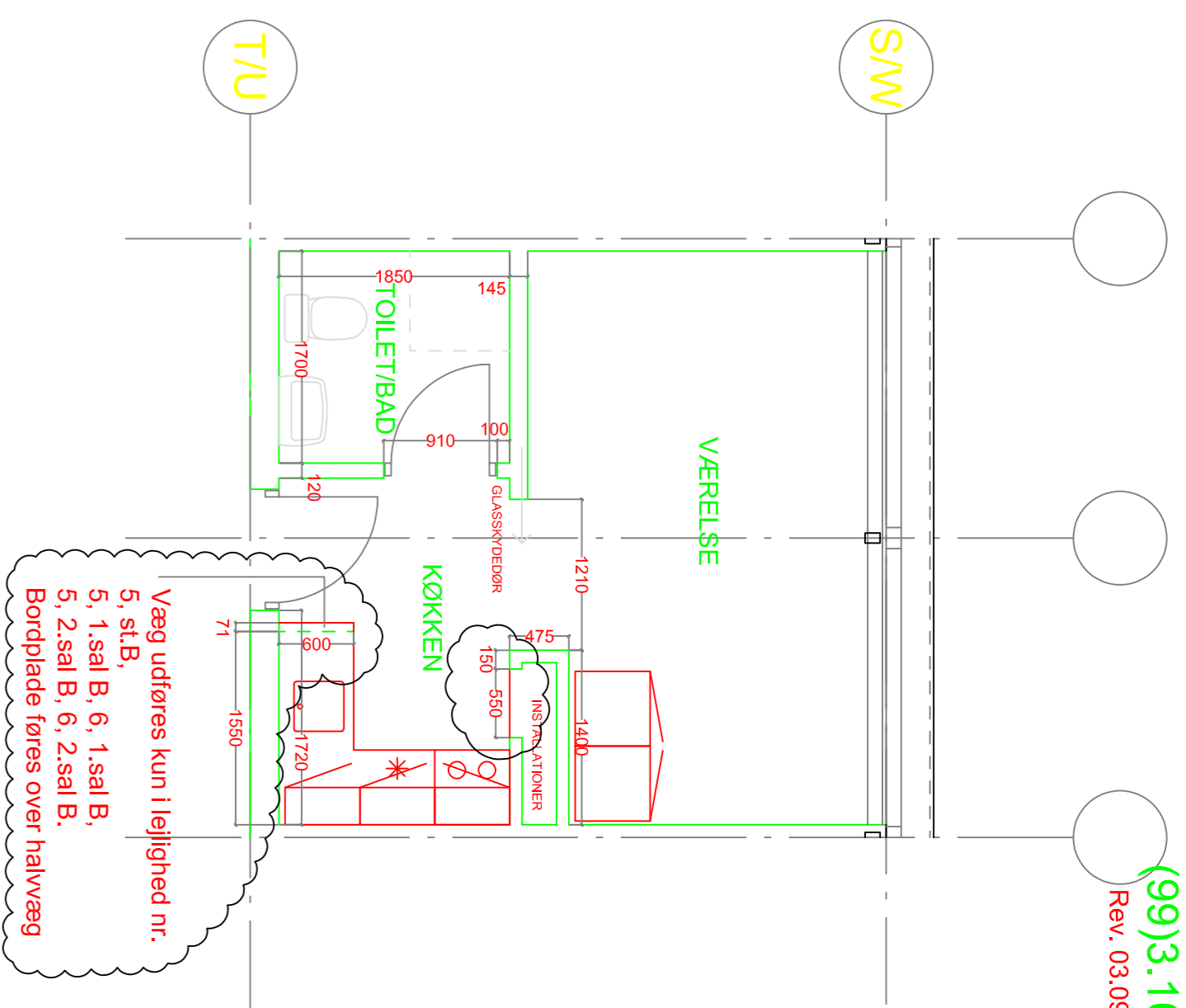

LEJLIGHEDSTYPE A
1 VÆRELSE

4 stk. stueplan
10 stk. 1. sal, heraf 6 spejlvendt
10 stk. 2. sal, heraf 6 spejlvendt

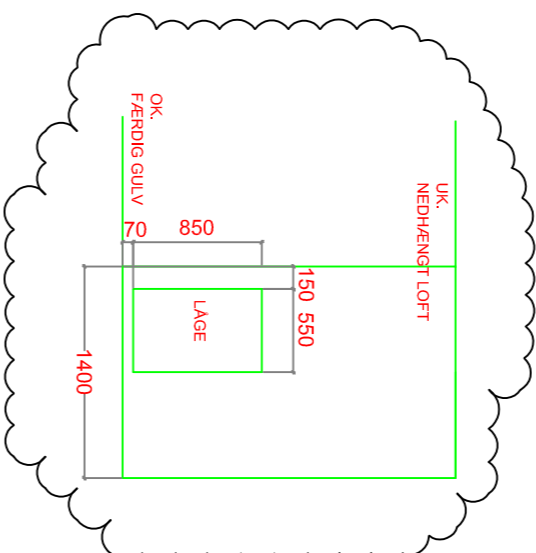

(99)3.10-05
Rev. 03.09.2007

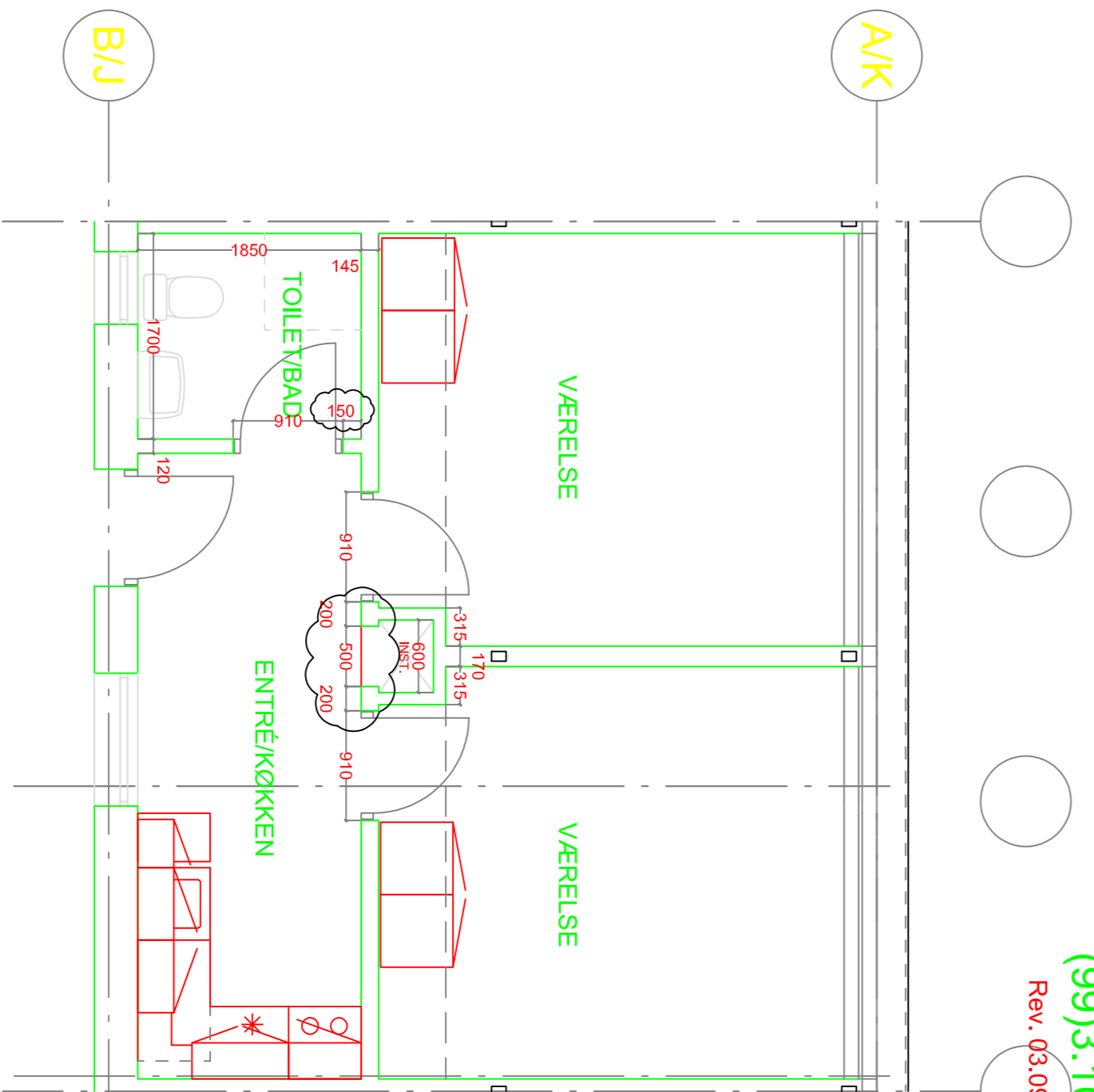

LEJLIGHEDSTYPE E
DUBLETTER

4 stk. stueplan, heraf 1 spejlvendt
5 stk. 1. sal, heraf 1 spejlvendt
5 stk. 2. sal, heraf 1 spejlvendt

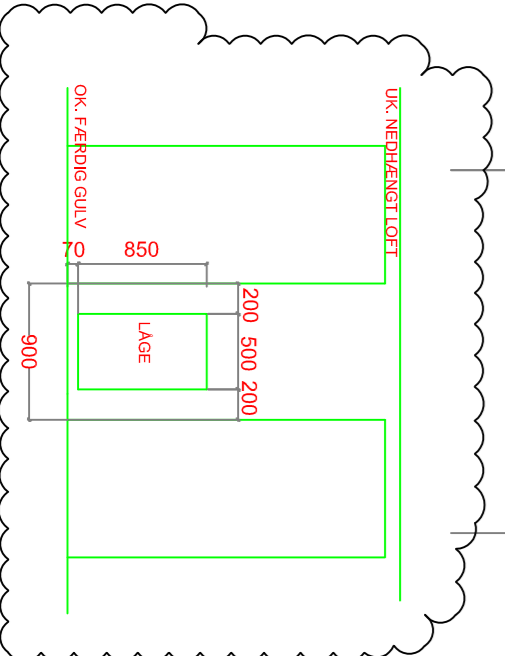

(99)3.10-02
Rev. 03.09.2007

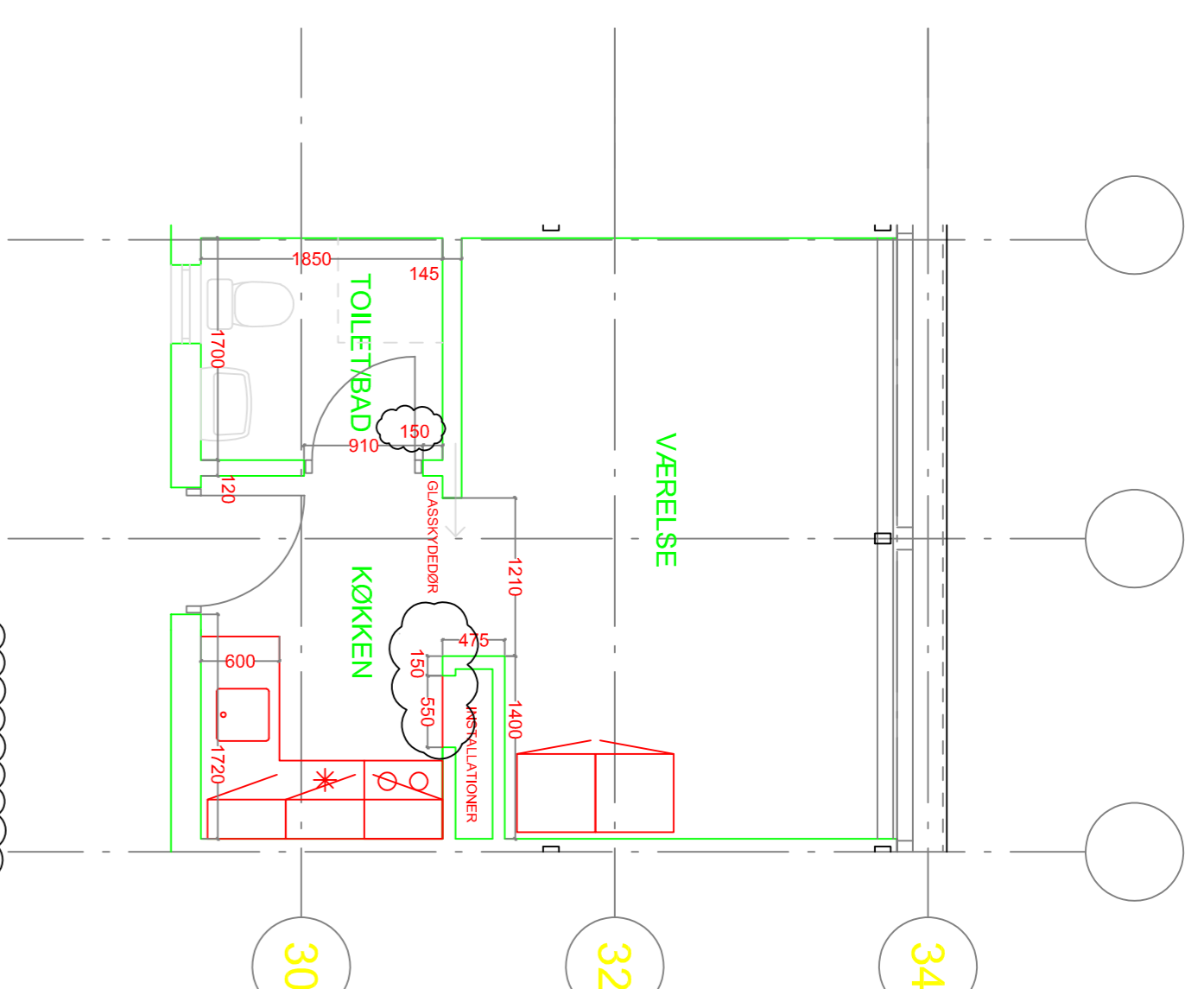

LEJLIGHEDSTYPE B
1 VÆRELSE

3 stk. stueplan
4 stk. 1. sal
4 stk. 2. sal

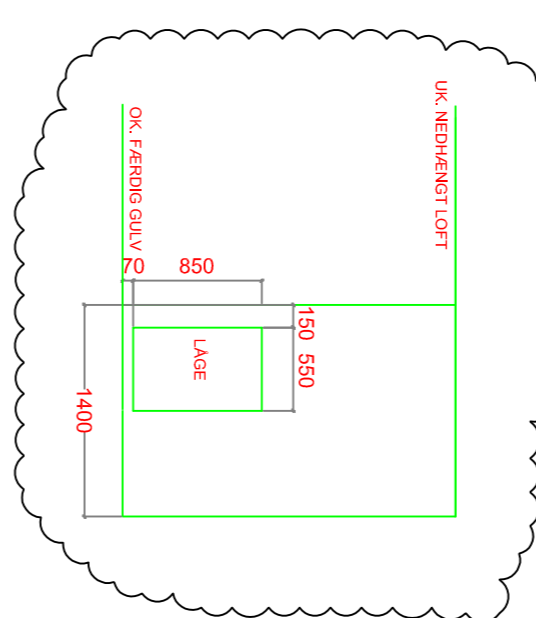

(99)3.10-06
Rev. 03.09.2007

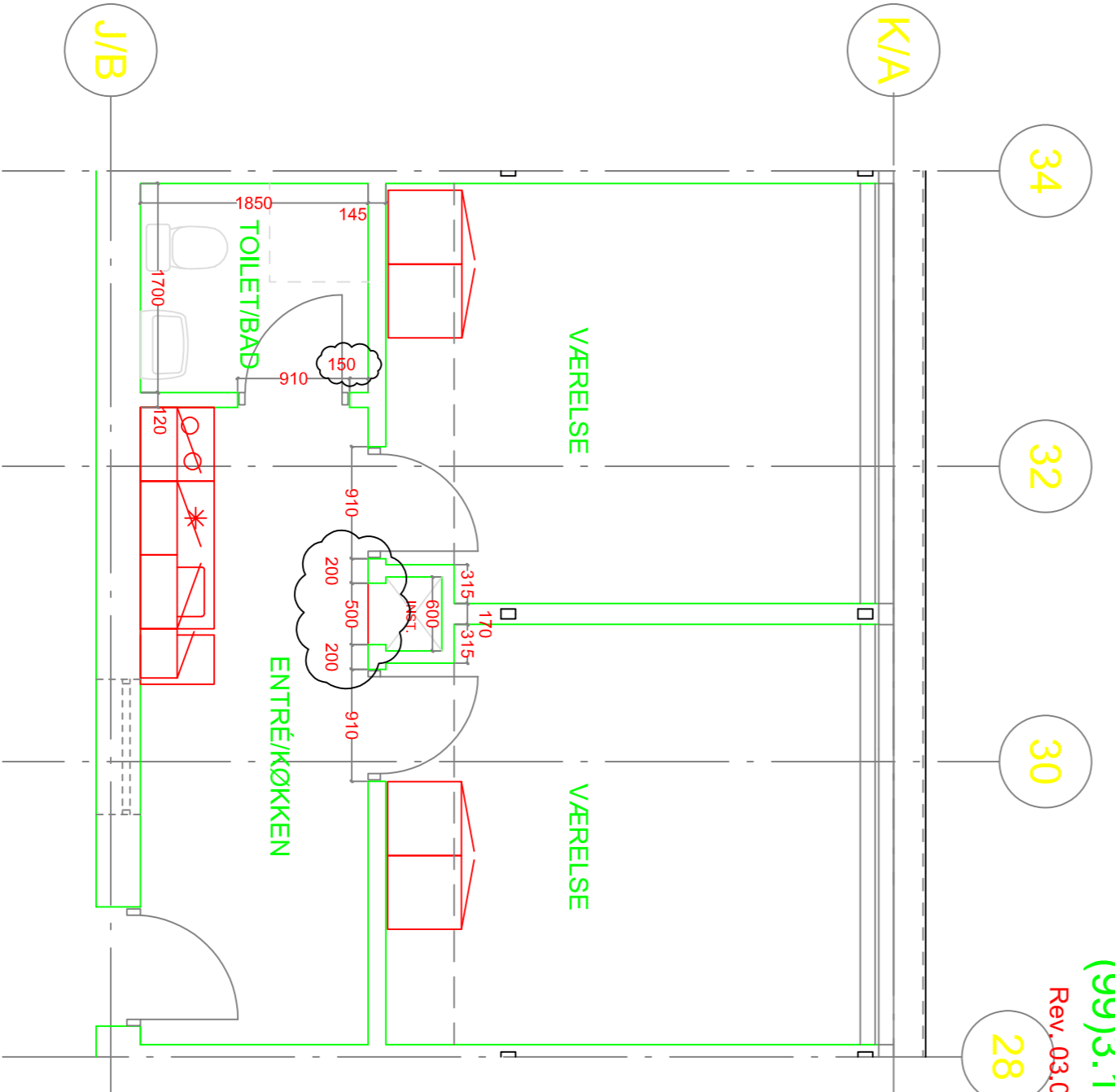

LEJLIGHEDSTYPE F
DUBLETTER

2 stk. stueplan, heraf 1 spejlvendt
2 stk. 1. sal, heraf 1 spejlvendt
2 stk. 2. sal, heraf 1 spejlvendt

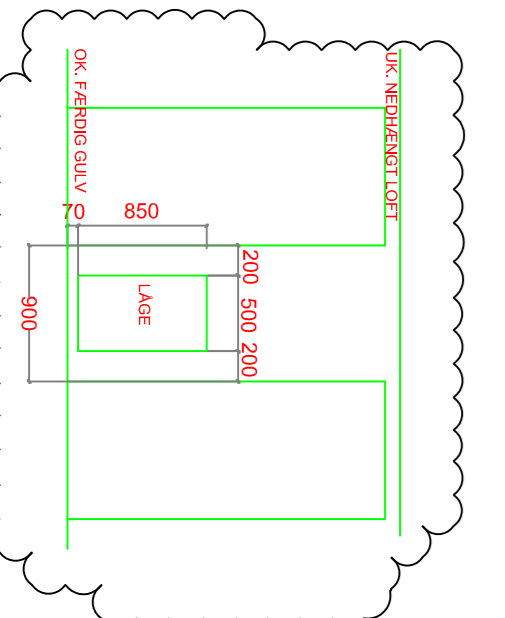

(99)3.10-03
Rev. 03.09.2007

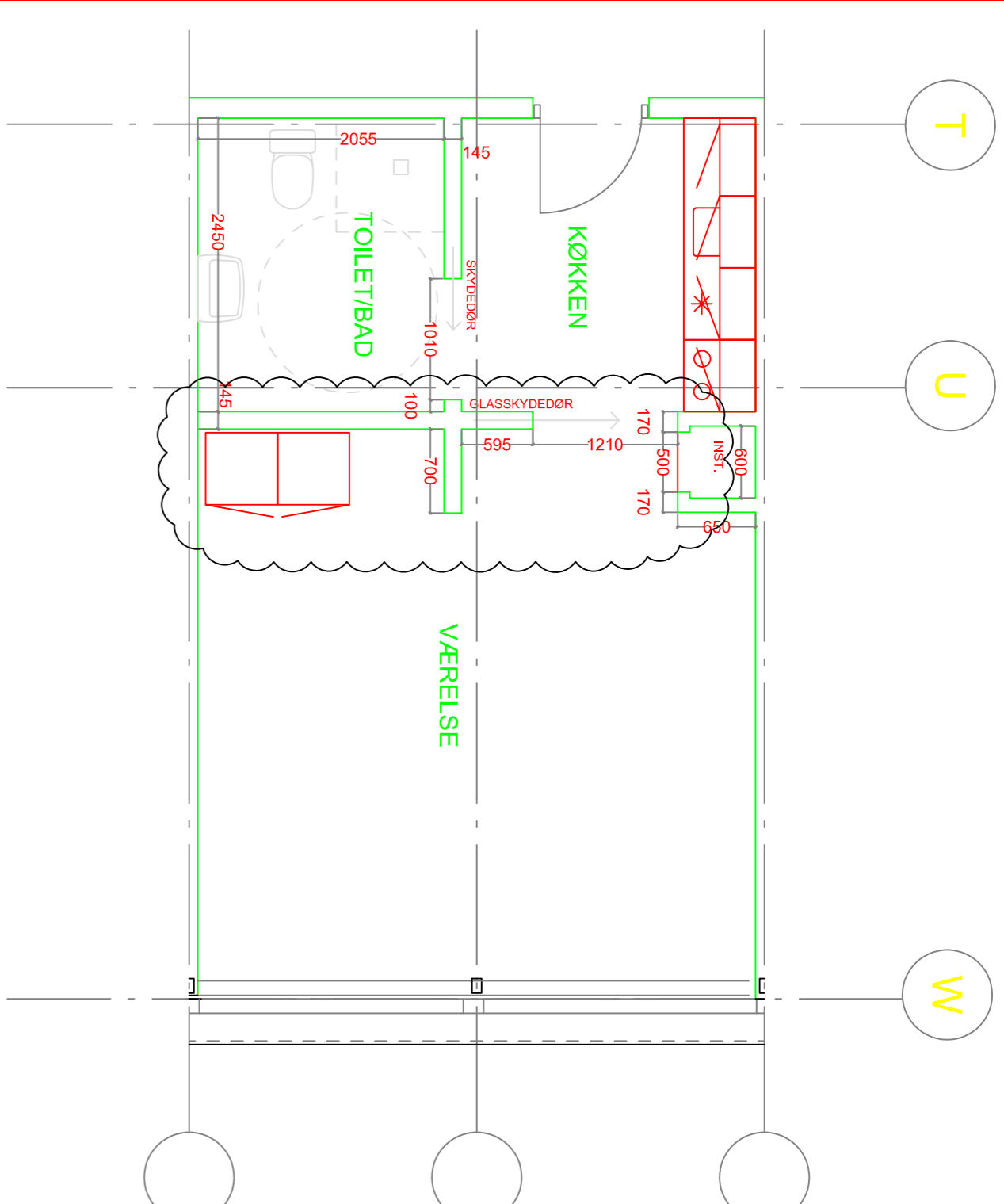

LEJLIGHEDSTYPE C
1 VÆRELSE (HANDICAPENET)

2 stk. 1. sal
2 stk. 2. sal

Rev. C:
Der udføres ikke gipsfriser ved værelse, gælder både 1. og 2. sal

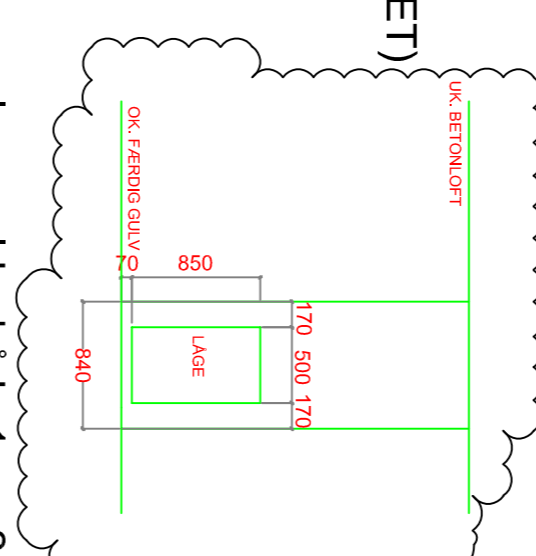

(99)3.10-07
Rev. 03.09.2007

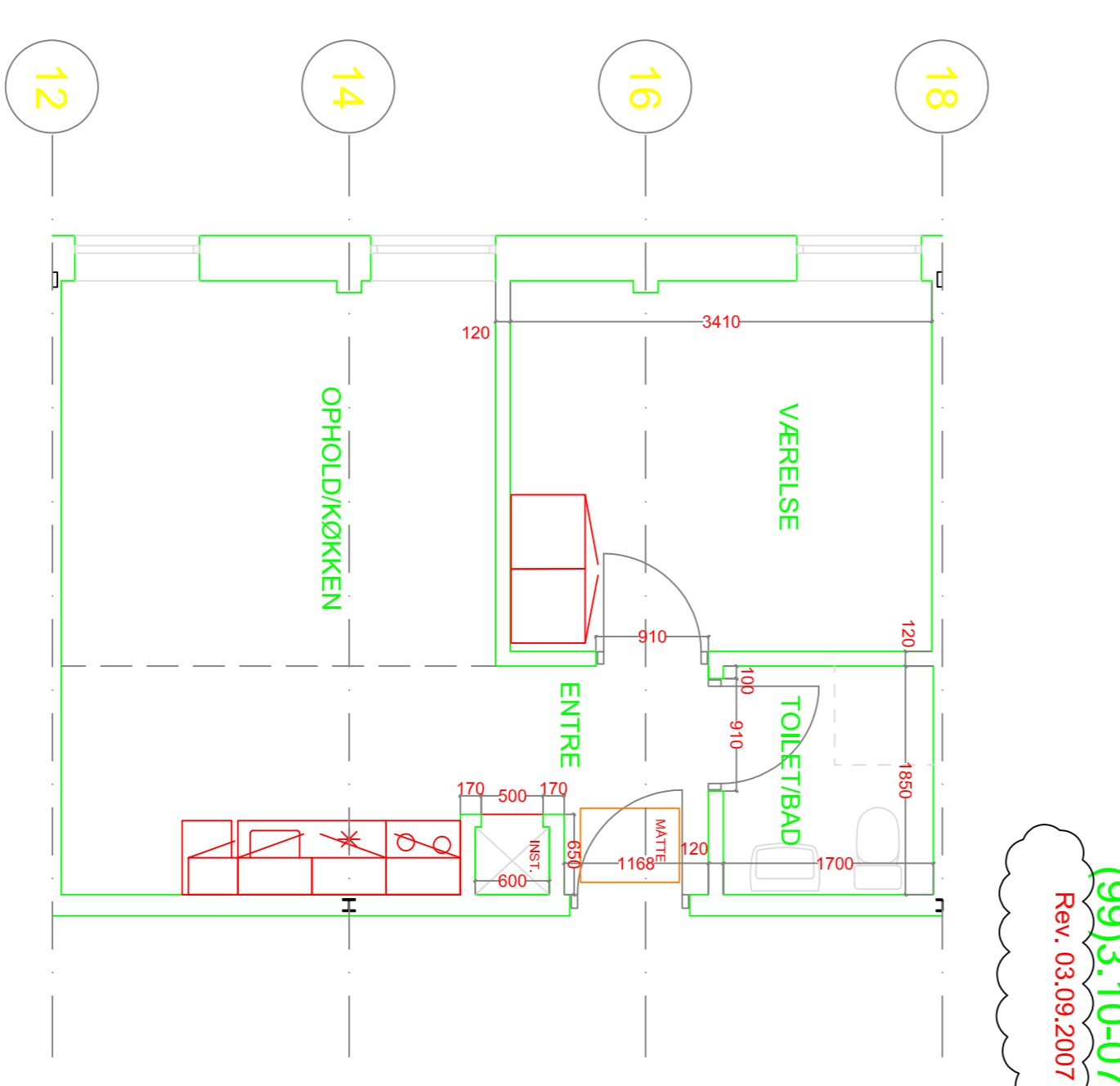

LEJLIGHEDSTYPE G
2 VÆRELSE

1 stk. stueplan
1 stk. 1. sal
1 stk. 2. sal

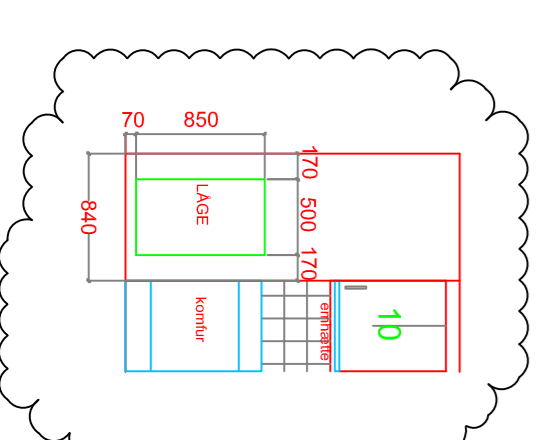

(99)3.10-04
Rev. 03.09.2007

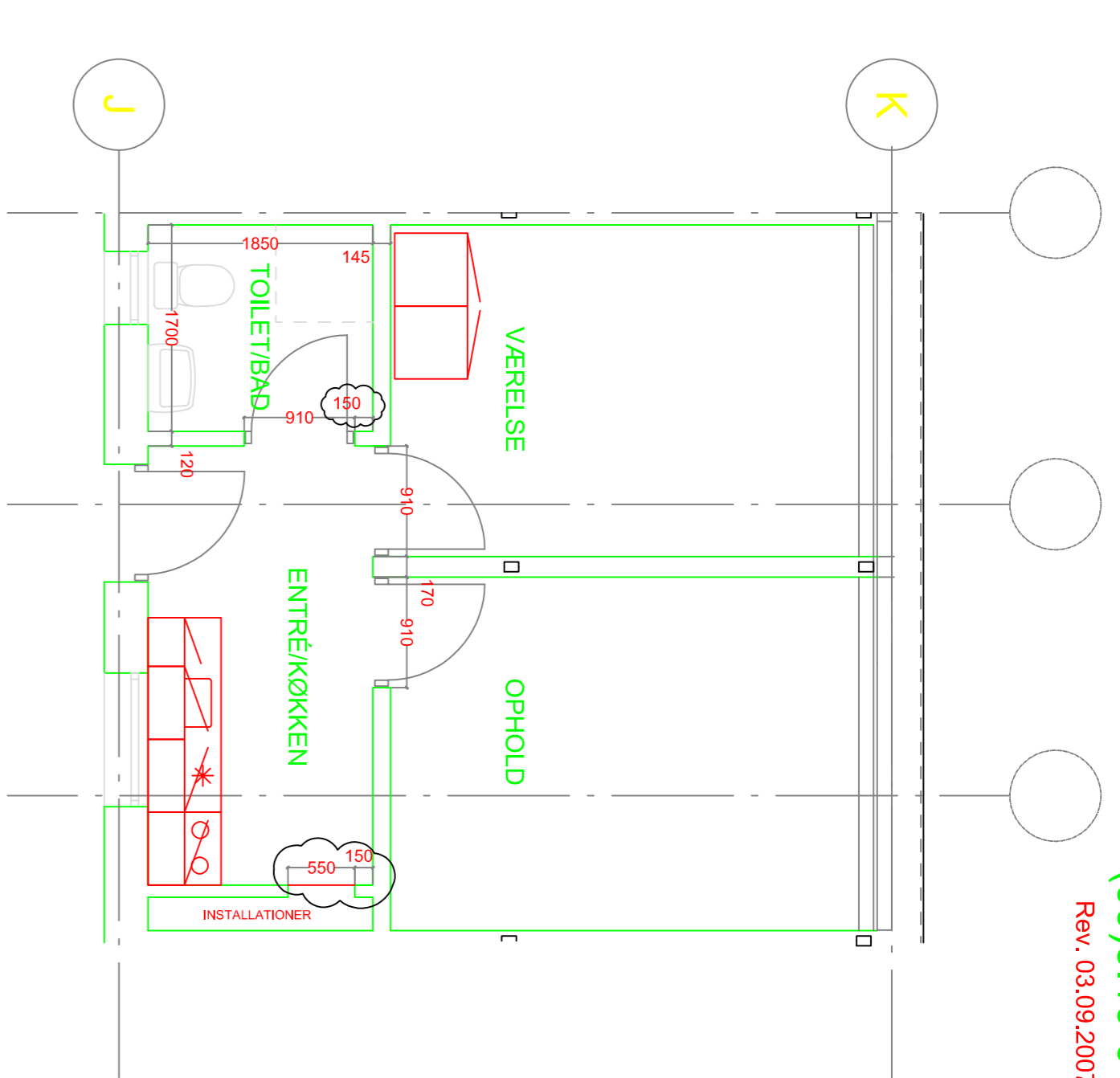

LEJLIGHEDSTYPE D
1½ VÆRELSE

2 stk. stueplan
4 stk. 1. sal
4 stk. 2. sal

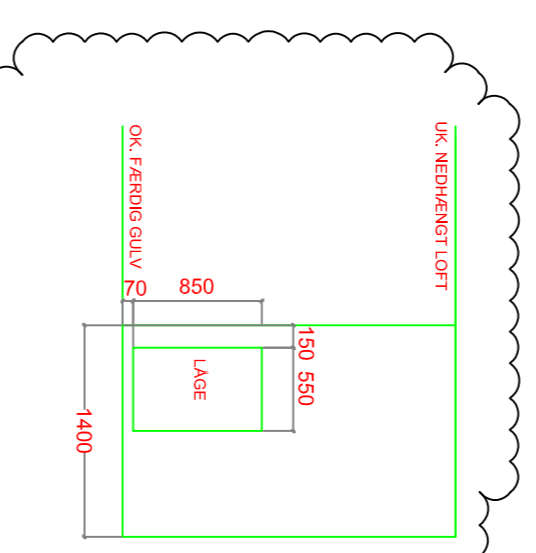

(99)3.10-08
03.09.2007

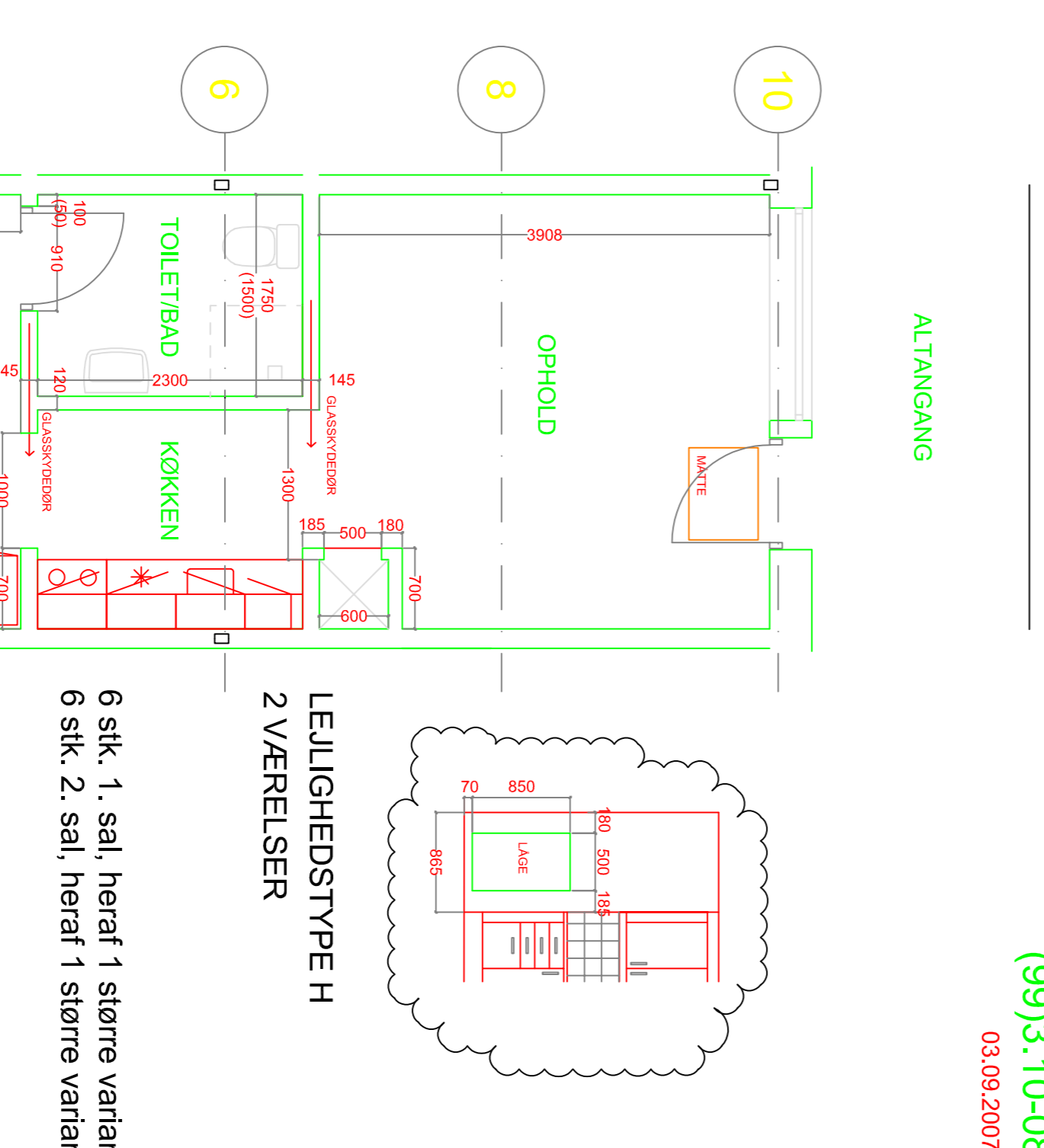

LEJLIGHEDSTYPE H
2 VÆRELSE

6 stk. 1. sal, heraf 1 større variant
6 stk. 2. sal, heraf 1 større variant

